

FOR REFERENCE ONLY

*2018 BENCHMARK NETWORK ADJUSTMENT SUPERSEDES THE 2003 BENCHMARK BOOK

Township 18 South, Range 60 East
Southwest Quarter

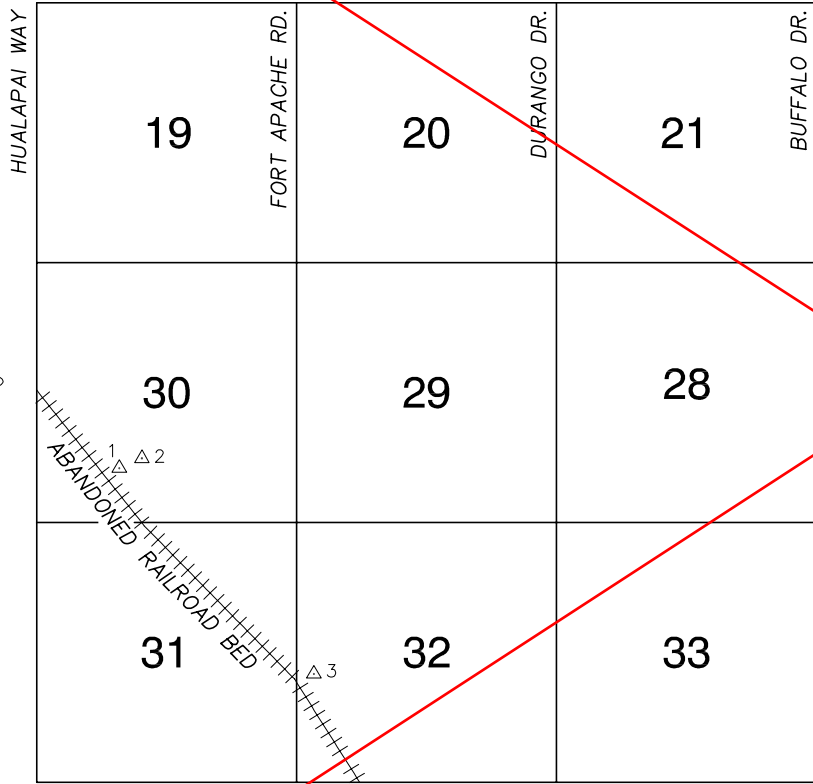

MOCCASIN RD.

NORTH AMERICAN VERTICAL
DATUM OF 1988
- ALL ELEVATIONS IN METERS -

No.	STATION	ELEVATION (METERS)	DESCRIPTION
1	W 365 1965	823.361	F N D USC&GS BRASS CAP, IN CONCRETE, STAMPED "W365 1965", 2' NORTHWEST OF A WOODEN POWER POLE WITH NO NUMBER, 1.01 MILES NORTHWEST OF THE INTERSECTION OF LOG CABIN WAY AND EL CAPITAN WAY ALONG AN ABANDONED RAILROAD BED.
2	X 314 1950	823.231	F N D USC&GS BRASS CAP, IN CONCRETE, STAMPED "X314 1950", 37' NORTHWEST OF W365, NEAR POWER POLE # P88555.
3	BM 112 1907	806.723	F N D 4" BRASS CAP ON AN IRON PIPE, 1.7' ABOVE THE GROUND. 101' SOUTHWEST OF A WOODEN POWER POLE WITH NO NUMBER, 2.1 MILES NORTHWEST OF THE INTERSECTION OF LOG CABIN WAY AND EL CAPITAN WAY ALONG AN ABANDONED RAILROAD BED.
4			LOST 2003
5			
6			
7			
8			
9			
10			

CLARK COUNTY VERTICAL CONTROL v.2003

CLARK COUNTY SURVEYOR'S OFFICE
5051 SOUTH PARADISE ROAD
LAS VEGAS, NEVADA 89119
(702) 455-0640

CONVERSION FACTOR:
METERS X $\left(\frac{3937}{1200}\right)$ = U.S. SURVEY FEET

REVISED 2003 SHEET 1 OF 1 18-60 SW